

***Optimal comfort –
maximum reliability***



DENTURE RELINER

Denture relining material for long-lasting
comfort and maximum reliability

Denture reliners for all situations

- + Direct denture relining
- + Excellent precision fit
- + Precision handling
- + Long-lasting stability and reliability

SOFRELINER TOUGH M_(MEDIUM) & S_(SOFT)

Permanent and temporary soft relining material

Field of application – denture relining

SOFRELINER TOUGH, available in Soft and Medium, provides an appropriate material for every patient's needs. SOFRELINER TOUGH will reduce pain caused by a sharp alveolar ridge, after surgery or during implant healing. For an atrophic ridge, SOFRELINER TOUGH creates extra denture adhesion. SOFRELINER TOUGH is very stable and extremely long lasting.

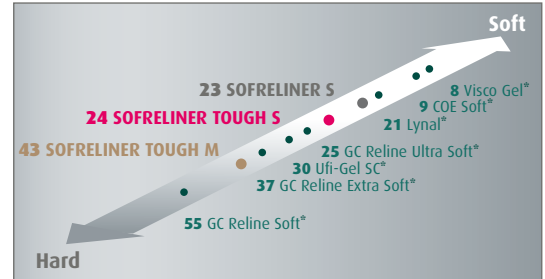
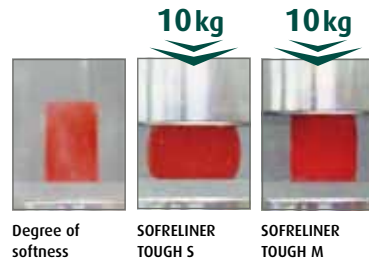

SOFRELINER TOUGH M Soft relining material

INDICATIONS

- + Pain caused by sharp ridges of alveolar bone and atrophy of mucosa
- + Poor retention caused by extreme ridge atrophy
- + Major undercuts or maxillary/mandibular tori
- + Retention of over dentures before the final attachment is placed

PROPERTIES

- + 100% addition-cured silicone
- + Shore hardness 43
- + Shelf life 2½ years
- + Extreme tear resistance
- + Surface and shade stability
- + Excellent precision fit



SOFRELINER TOUGH M offers long-term solution for stable and reliable denture relining.

SOFRELINER TOUGH S Extra soft relining material

INDICATIONS

- + Pain caused by sharp ridges of alveolar bone and atrophy of mucosa
- + Poor retention caused by extreme ridge atrophy
- + Major undercuts or maxillary/mandibular tori
- + Retention of over dentures before the final attachment is placed
- + **Temporary relining or tissue conditioning (Only TOUGH S)**

PROPERTIES

- + 100% addition-cured silicone
- + Shore hardness 24
- + Shelf life 6 months
- + Surface and shade stability
- + Excellent precision fit



SOFRELINER TOUGH S offers short-term treatment for highly sensitive patients or after surgery.

Application – precise and easy handling

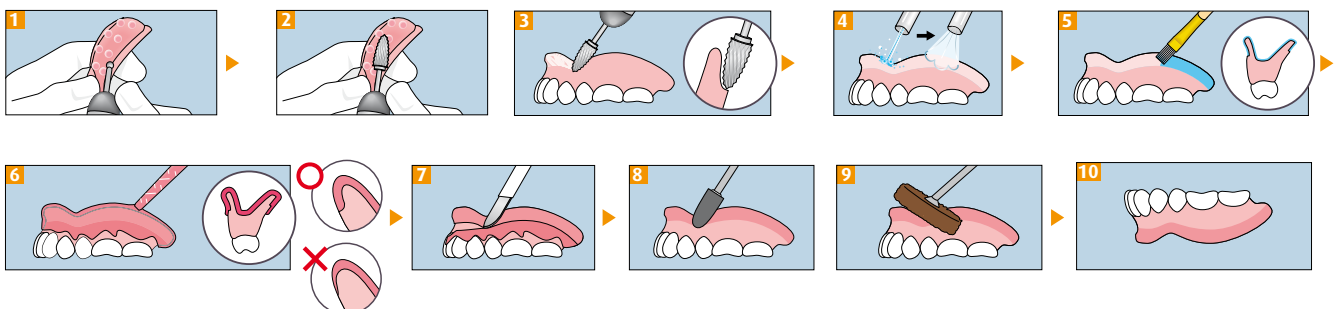

Long-lasting and reliable

The high adhesive strength of Sofreliner Tough ensures long-lasting adhesion between the reline and denture. A peel test demonstrates the excellent

bond between the base of the denture and the reline, showing no signs of detachment under load.

Peel test

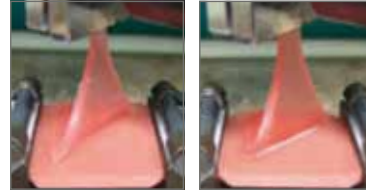

SOFRELINER TOUGH S

Conventional product

High tear resistance

SOFRELINER TOUGH M and S have high tear resistance compared to other relining materials. They do not tear in daily use.

Peel test comparison study

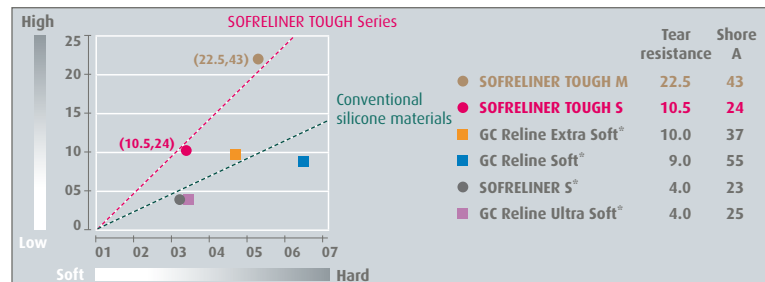

Surface and shade stability

SOFRELINER TOUGH retains long-term surface integrity. This protects against the contamination odours that occur with

other materials. SOFRELINER TOUGH, compared to other relining materials, has high resistance to discolouration.



SOFRELINER TOUGH M - firm denture margins after over 2½ years.

Surface stability test (4 weeks of immersion in water at 37°C)

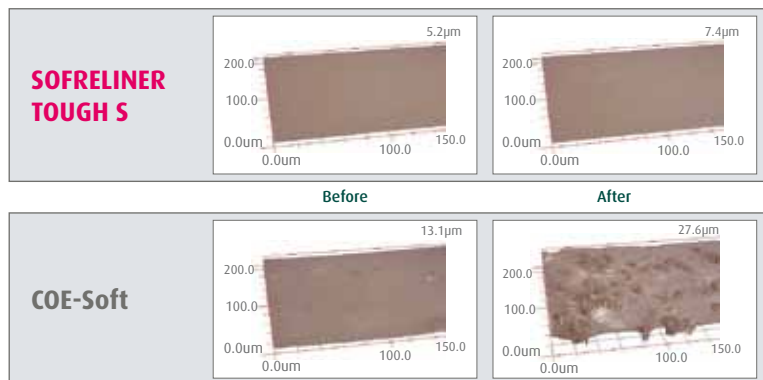

Denture relining after over 2½ years.

SILICONE REMOVER

Easy removal of DENTURE RELINER

SOFRELINER TOUGH M and S can be easily removed in one piece with the aid of SILICONE REMOVER, without grinding. This ensures rapid, neat detachment of the reliner from the denture.

Removal of reliner with SILICONE REMOVER

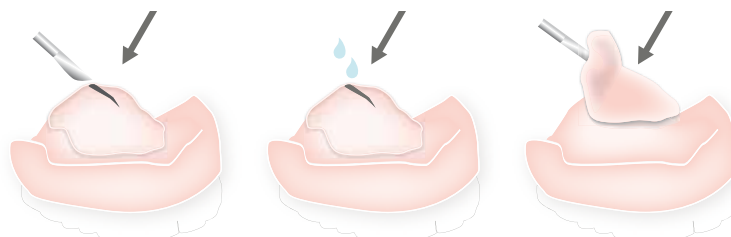

TOKUYAMA REBASE II

Hard relining material



REBASE II is a hard chairside reline material that can also be used in the dental laboratory. Intraorally, REBASE II cures within 5 minutes with minimal heat and no odour. REBASE II is used for relining full and partial dentures.

INDICATIONS

- + Long-lasting hard relining material
- + Relining complete dentures
- + Relining partial dentures
- + Following soft relining, when the mucosa has healed
- + Chairside use

PROPERTIES

- + MMA-free
- + No development of odour
- + Excellent precision fit / optimal comfort
- + Minimal generation of heat
- + Time-saving
- + Reduces laboratory costs

Standard time of use for REBASE II

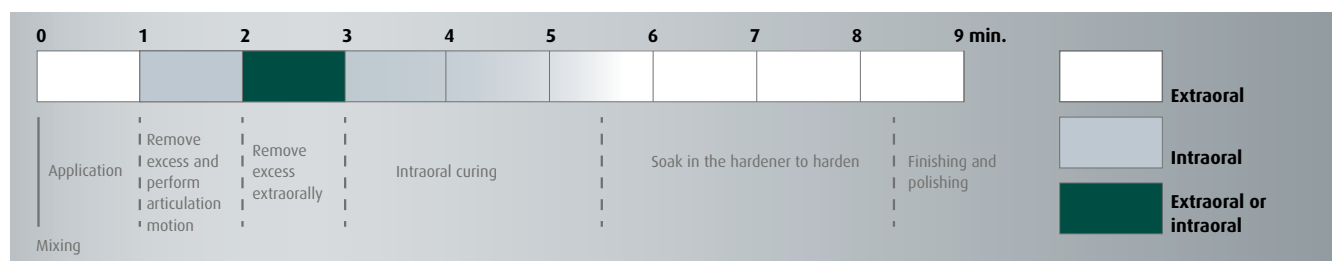

SOFRELINER TOUGH S



SOFRELINER TOUGH S Kit

or individually:
 2 x 26g cartridge
 Primer 10ml
 Polishing system kit
 Dispenser II
 Mixing Tip XS, 50 pcs.
 Mixing Tip S, 50 pcs.

SOFRELINER TOUGH M



SOFRELINER TOUGH M Kit

or individually:
 2 x 27g cartridge
 Primer 10ml
 Shape adjustment point, white
 Finishing point, brown
 Diamond round point
 Dispenser II
 Mixing Tip XS, 50 pcs.
 Mixing Tip S, 50 pcs.

REBASE II



REBASE II Kit

or individually:
 Powder 80g
 Liquid 50ml
 Adhesive 15ml
 Hardener 48g

SILICONE REMOVER



SILICONE REMOVER

Bottle 7ml



Tokuyama Dental Deutschland GmbH

Siemensstrasse 46 | 48341 Altenberge | Germany

Tel.: +49 (0)2505 938513 | Fax: +49 (0)2505 938515

www.tokuyama-dental.de | info@tokuyama-dental.de